

ROAD BIKE RIM



23mm Width 88mm Depth CARBON FIBER TUBULAR

SPECIFICATION

Item #	NXT88T02
Type	Tubular
Material	Toray T700 Carbon Fiber
Size	700C
Width	23mm
Depth	88mm
ERD	465mm
Weight	495+/-15g
Weave	UD / 3K / 12K
Spoke Hole Dia.	4.5mm
Valve Hole Dia.	6.5mm
Assembly Hole Dia.	7.5mm
Hole count	16,18,20,24,28,32,36
Application	Road / Triathlon / TT / Cyclocross



PROFILE

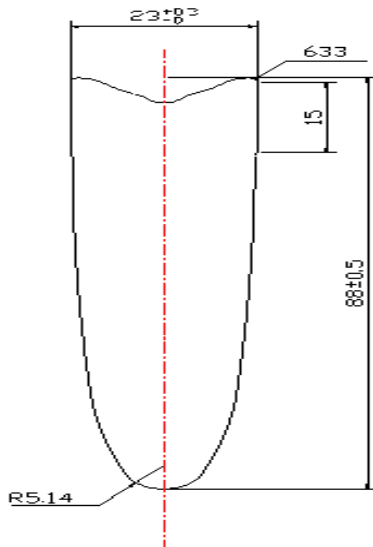

RECOMMENDATION

Max Tire Pressure	145psi
Max Spoke Tension	130kgf
Max Weight Limit	130kg
Spoke Nipple Length	14mm/16mm

FEATRURES

Basalt Braking Surface: This rim has a high-temperature resistant basalt braking surface that dissipates heat build-up and provides consistently solid braking, even in hot temperatures on long descents. No Aluminum braking surface needed! Less rotational weight = faster acceleration!